

Price £240,000

Jasmine Place, Southsea PO5 2FJ

bernards
THE ESTATE AGENTS



HIGHLIGHTS

- ❖ BRAND NEW DEVELOPMENT
- ❖ CONVERTED SCHOOL
- ❖ PART OF SOUTHSEA HISTORY
- ❖ ONE BEDROOMS
- ❖ OPEN PLANNED LIVING AREA
- ❖ THREE PIECE BATHROOM
- ❖ DOUBLE BEDROOMS
- ❖ UNFURNISHED
- ❖ PARKING NEGOTIABLE
- ❖ MOVE IN JULY

5% DEPOSIT CONTRIBUTION PAID BY DEVELOPER

Welcome to this brand new one bedroom flat in the heart of Southsea, set within a contemporary development designed for modern living in a lively, well connected area.

The property features a spacious open plan kitchen and living area, offering a welcoming environment that's perfect for both relaxing and entertaining. The well proportioned bedrooms provide comfortable

accommodation, perfect for winding down at the end of the day. A stylish, modern bathroom with high quality fittings completes the home.

Its central location is a standout feature, with a range of local amenities, including shops, cafés, and parks just a short walk away. Convenient public transport links also make commuting to surrounding areas straightforward.

Call today to arrange a viewing

02392 864 974

www.bernardsea.co.uk





Call today to arrange a viewing
02392 864 974
www.bernardsestates.co.uk



PROPERTY INFORMATION

Tenant Fee Act 2019

Tenant Fees Act 2019

As well as paying the rent, you may also be required to make the following permitted payments.

For properties in England, the Tenant Fees Act 2019 means that in addition to rent, lettings agents can only charge tenants (or anyone acting on the tenant's behalf) the following permitted payments:

- Holding deposits (a maximum of 1 week's rent);
- Deposits (a maximum deposit of 5 weeks' rent for annual rent below £50,000, or 6 weeks' rent for annual rental of £50,000 and above);
- Payments to change a tenancy agreement eg. change of sharer (capped at £50 or, if higher, any reasonable costs);
- Payments associated with early termination of a tenancy (capped at the landlord's loss or the agent's reasonably incurred costs);
- Where required, utilities (electricity, gas or other fuel, water, sewerage), communication services (telephone, internet, cable/satellite television), TV licence;

- Council tax (payable to the billing authority);
- Interest payments for the late payment of rent (up to 3% above Bank of England's annual percentage rate);
- Reasonable costs for replacement of lost keys or other security devices;
- Contractual damages in the event of the tenant's default of a tenancy agreement; and
- Any other permitted payments under the Tenant Fees Act 2019 and regulations applicable at the relevant time.

Right to Rent

Each applicant will be subject to the right to rent checks. This is a government requirement since February 2016. We are required to check and take a copy of the original version of acceptable documentation in order to adhere to the Right to rent checks. This will be carried out at referencing stage. Please speak to a member of staff for acceptable Identification.



Energy Efficiency Rating		Current	Potential
Very energy efficient - lower running costs			
(92 plus)	A		
(81-91)	B		
(69-80)	C		
(55-68)	D		
(39-54)	E		
(21-38)	F		
(1-20)	G		
Not energy efficient - higher running costs			
England & Wales		EU Directive 2002/91/EC	



3RD FLOOR
563 sq.ft. (52.3 sq.m.) approx.

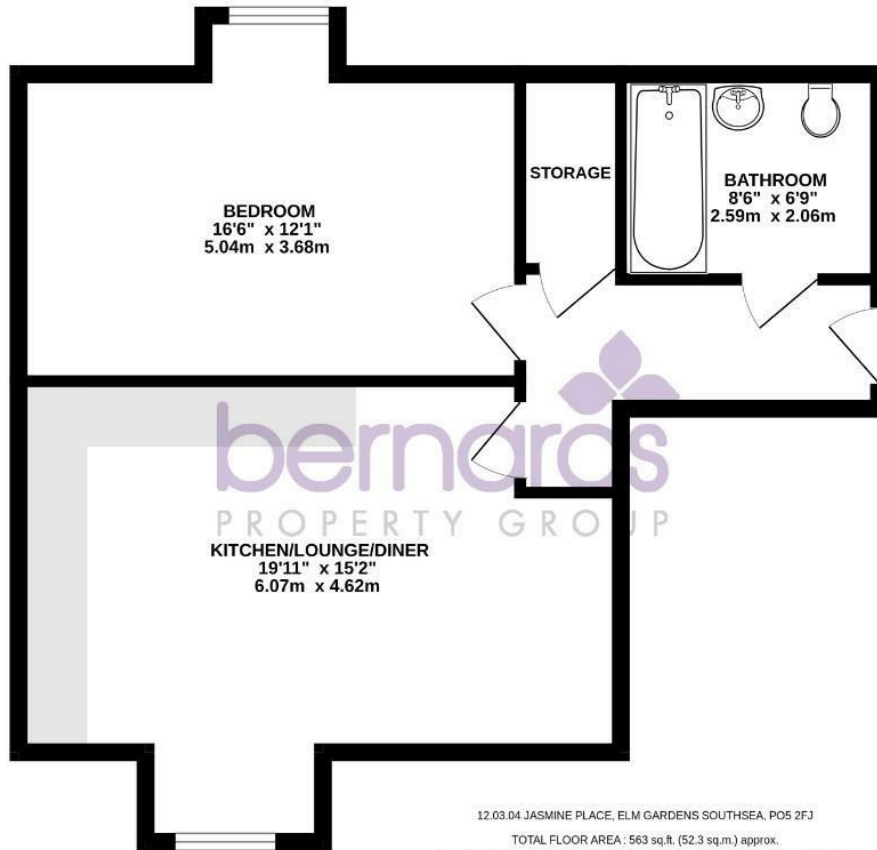

12.03.04 JASMINE PLACE, ELM GARDENS SOUTHSEA, PO5 2FJ

TOTAL FLOOR AREA: 563 sq.ft. (52.3 sq.m.) approx.

Whilst every attempt has been made to ensure the accuracy of the floorplan contained here, measurements of doors, windows, rooms and any other items are approximate and no responsibility is taken for any error, omission or mis-statement. This plan is for illustrative purposes only and should be used as such by any prospective purchaser. The services, systems and appliances shown have not been tested and no guarantee as to their operability or efficiency can be given.
Made with Metropix 4/2026

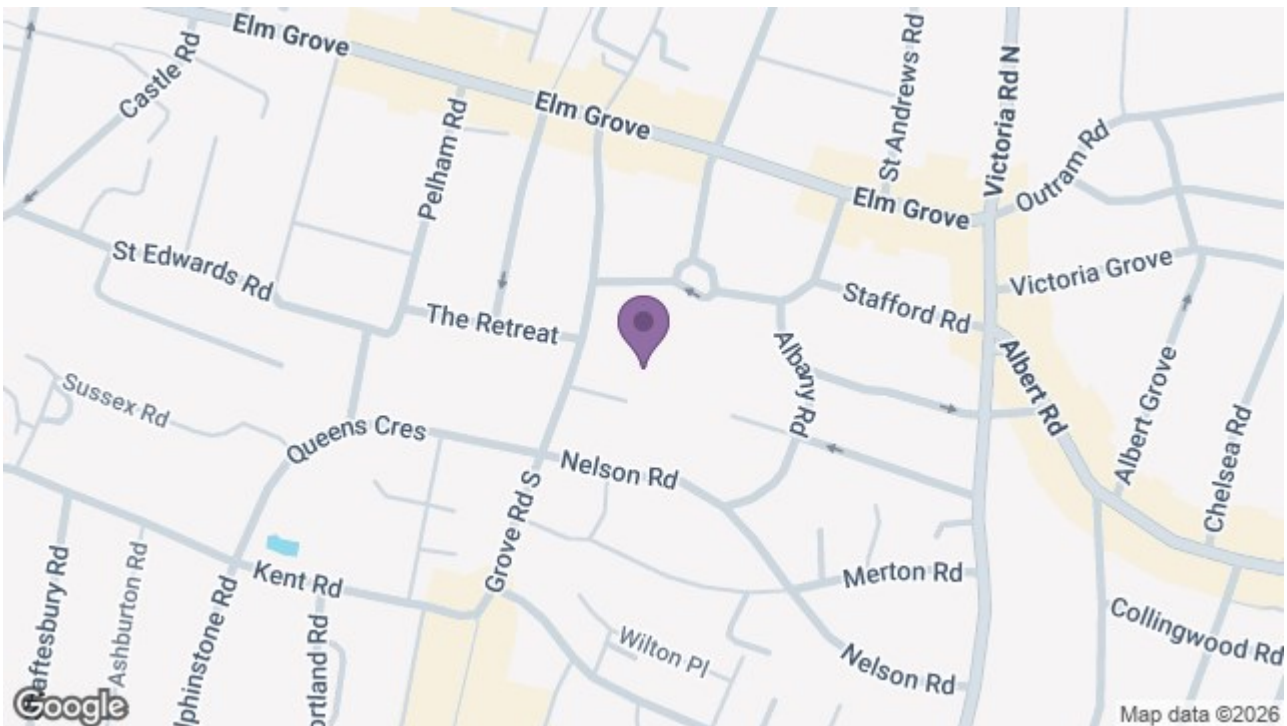

8 Clarendon Road, Southsea, Hampshire, PO5 2EE
t: 02392 864 974

